

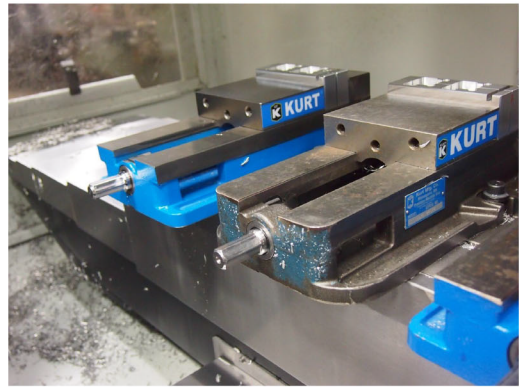

ARZ Machining Inc. is a precision CNC machine shop located 20 miles North of Milwaukee in Grafton, WI. We employ a highly-skilled workforce and pride ourselves on quality and outstanding customer service.



CNC Milling (3 & 4 Axis)
 40" (X axis) x 20" (Y axis) x 25" (Z axis)
 Typical Production Tolerance: up to +/- 0.0005"



Laser Engraving
 12" x 24" Engraving Area – Max Material Thickness: 5"
 Materials: Steel, Stainless Steel, Brass, Bronze, Aluminum, Some Plastics
(Please inquire about plastics as some are not compatible with this type of laser)



CNC Turning (2 Axis)
 Up to 10" Diameter Turning Capacity
 Up to 3" Thru Spindle Bar Capacity
 Typical Production Tolerance: up to +/- 0.0005"
(Better for certain applications if required)

CNC Production Sawing
 +/- 0.01" Tolerance
 Capacity: Round: 10-1/4",
 Rectangle: 10-1/4" x 10-5/8",
 Square: 10-1/4"

Part Finishing
 Vibratory Finishing and Deburring
 Sandblasting (23" x 36" x 20" Work Envelope)

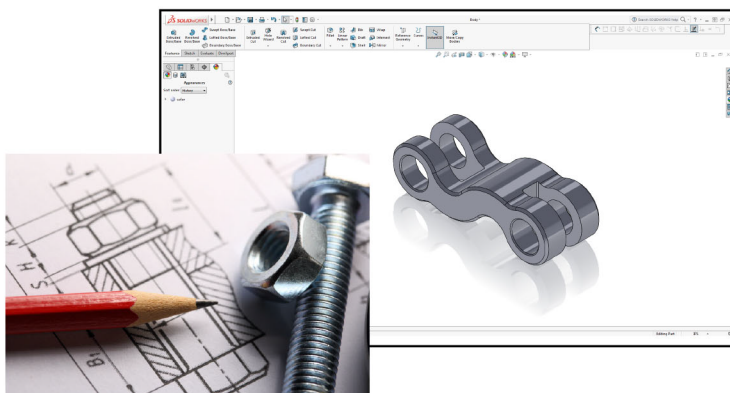

Design/Drafting Services
 Given a sketch or idea, we can complete the entire design process – From initial concept to physical prototype.
 CAD Design/Layout using Solidworks
 Create and/or Edit Detailed Drawings
 Create and/or Edit 3d Solid Models
 3D printing (8.5" x 8.5" x 8" Build envelope)
 We can work with you to review final part design and simplify part if possible to reduce manufacturing cost without compromising on functionality or quality.

Value Added Services:

Assembly | Packaging

Let us be your one stop shop for all your manufacturing needs. We have developed a relationship and work closely with a select group of outside vendors to provide added services such as heat treating, black oxide, anodizing, hardcoating, powder coating, welding, metal forming and much more.